

# Outdoor AC/DC Power Systems for IoT Applications

Ensure reliable power for LPWAN, Cellular, SCADA and Wi-Fi deployments

Ventev's Outdoor AC/DC Power Systems for IoT applications ensure reliable power for LPWAN, Cellular, SCADA and Wi-Fi radios. The compact, lightweight NEMA 4X enclosure systems convert 120VAC site power to 12VDC to power active equipment or convert to PoE/PoE+ if needed. The systems are easily configurable in the field, or have them delivered fully integrated to meet your specific deployment requirements. Mounts on poles or walls. *For questions and assistance purchasing product, contact Ventev: 800-851-4965 or sales@ventev.com.*



AC/DC Power System	TESSCO No. 254543	P/N: VPE-12-60-000000
System with UPS Battery	TESSCO No. 244301	P/N: VPE-12-60-000700
Multiple System configurations available. Call Ventev to order.		

## APPLICATIONS

- **Outdoor Wi-Fi** - converts 120VAC to 1-2 PoE ports for outdoor access points
- **Smart Grid** - powers collector point systems for LTE backhaul radios with enclosure I/O ports for antenna cables
- **Smart Farming** - provides 12VDC to power LPWAN Gateway radio systems with accommodations for external 900MHz and LTE antennas
- **SCADA Networks** - Protects remote equipment and provides 12VDC power to SCADA radio with UPS and integrated antennas

## FEATURES

- Converts AC power to DC power
- Rugged NEMA-rated enclosure protects in harsh weather
- Lightweight and low profile
- Locks to secure equipment from tampering and theft
- Pole or wall mountable

## BENEFITS

- **Configured and delivered fully integrated** for fast, trouble-free installation
- **Cost-effective solution** for ensuring reliable power for uninterrupted connectivity
- **Convenient, one-stop purchase** - Power System and all optional integrated components can be purchased through TESSCO

## CONFIGURE WITH OPTIONAL COMPONENTS:



Cell modems, LPWAN, SCADA & Wi-Fi radios



Network switches



Industrial POE injectors



Battery and enclosure monitors



Surface mount antennas for LTE, GPS, WiFi



Batteries for UPS capability

**POWERED SYSTEMS PRODUCT NO: VPE — 00 — 00 — 0 — 0 — 00**

12VDC= **12**

60W= **60**

**ANTENNA**

Yes= **1**

No = **0**

**POE INJECTOR**

Yes = **1**

No = **0**

**BATTERY**

7ahr = **07**

2x7ahr = **14**

17ahr = **17**

# Outdoor AC/DC Power Systems for IoT Applications

*Ensure reliable power for LPWAN, Cellular, SCADA and Wi-Fi deployments*

Base AC/DC Power System	
<b>Output Power</b>	60W@12VDC
<b>Input Power</b>	90 to 264VAC 60 Hz, 3.5 amp.
<b>System Protections</b>	DC input fuse protection, Short circuit protection (auto-reset), Low Voltage Disconnect: Included (cutoff voltage 10.5, reconnect voltage 12.5)
<b>Terminal Blocks</b>	AC with knife switch, DC for 12V and ground
<b>Environmental Temperature Range</b>	-35C to +60C (-31F to + 140F)
<b>Dimensions</b>	12"H x 10"W x 6"D
<b>Enclosure</b>	NEMA 4X Grey polycarbonate, UL Listed, opaque hinged lid
<b>Theft and Weather Protection</b>	Pad lockable latches , moisture vent
<b>Enclosure Ports</b>	One port for AC-input, three ports for RJ45 I/O
<b>Weight w/ Batteries</b>	13 lbs
<b>Battery Backup System</b>	Built-in capability, wire harness included (but not installed)
<b>Included but not installed</b>	Battery harness for two batteries, one hole plug, four RJ45 glands, tabs for wall mounting

Enclosure Dimensions					
Enclosure Size	A	B	C	D	E
12" x 10" x 6"	14.00"	13.13"	11.50"	7.60"	12.50"
	<b>F</b>	<b>G</b>	<b>H</b>	<b>I x J</b>	<b>K</b>
	7.25"	6.75"	6.25"	8.25 x 10.25"	7.60"
	<b>L</b>	<b>M</b>	<b>N</b>	<b>O</b>	<b>Panel Size</b>
	9.63"	13.69"	12.75"	8.00"	10.75" x 8.88"

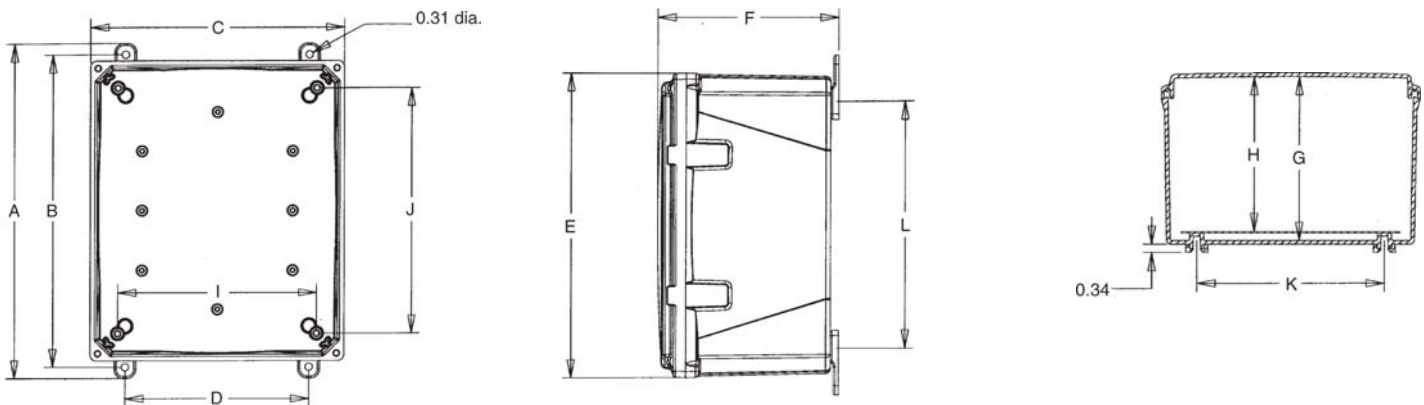

**Additional Accessories Available through TESSCO**

- Replacement batteries Yuasa 7Ahr Model NP7-12, TESSCO No. 532518
- Pole mount for <= 4" poles TESSCO No. 330781
- Universal pole mount <= 15" TESSCO No. 303580
- 1" Dia RJ45 compatible cable glands TESSCO No. 576422
- 1" dia hole plugs TESSCO No. 344873

**Notes**

- For AC input requirements >270VAC, call Ventev
- For extended battery backup time, call Ventev
- Site AC power cord provided by others